

OUTBOARD REST (Lots of alternatives and choices!)

Bed Extension

Powermatic supplied and shop-built ideas are detailed [HERE](#)

Use Kee Clamps to Join Pipe: Adapt this slick idea for the PM3520: Steve Harder says: "On my Nova 1624 I went for the homemade approach. Total project cost if you bought everything new would be around \$60. I already had the pipe, so I just needed to buy three Kee Klamps for \$30 and do a little welding and pipe cutting.

Google "Kee Klamp" - these fittings make an adjustable but very strong and solid connection between the pipe sections - be sure to get the correct size for pipe you are using.

I used 1 1/4" ID black pipe for most of the structure and then reduced to 1" ID - which makes a slightly loose but nice fit with existing tool rests."

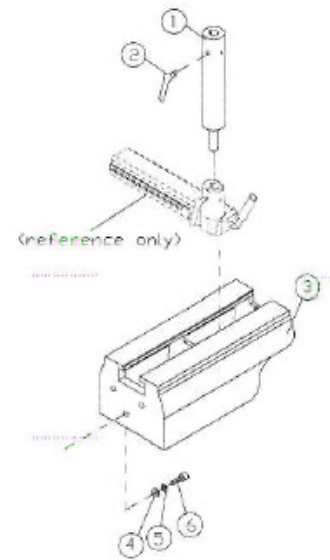

See discussion at: <http://www.woodcentral.com/cgi->



bin/turning.pl/page/1/md/read/id/238391/sbj/attached-outboard-toolrest/#m_238391

Combine this joinery technique with Wilford O. Bickel's shop made rest shown next down this page.



Shop made Outboard Tool Rest Stand

Designed by Wilford O. Bickel (See his article in "Woodturning Design" Winter 2008 issue [LINK](#) for back issue)

The one below was made by Chris Rolke discussed in Sawmill Creek Forum [HERE](#)



PM Supplied Extension with Rollie Bown's Shop built Outboard Rest



Vicmarc outboard attachment and instructions



- Vicmarc's description of their outboard rest.
<http://www.vicmarc.com/default.asp?contentID=545>
- Forum discussion and mounting instructions:
<http://www.aawforum.org/community/threads/284>
<http://www.aawforum.org/community/threads/1670>

Other outboard solutions

- Shop made of 1-1/4" and 1" galvanized pipe by Wilford Bickel: Woodturning Design Magazine, Winter 2008 issue



- <http://www.customwooddesign.com/woodturningaccessories-2.html>
- <http://turningaround.org/BanjoOutrigger.htm>
- <http://turningaround.org/31inColumnBases.htm>

